

**Memorex®**

**ARMBAND AM/FM RADIO WITH  
ALARM CLOCK**

**MODEL: MB221**

**BEFORE OPERATING THIS PRODUCT, PLEASE READ THESE  
INSTRUCTIONS COMPLETELY.**



**OPERATING INSTRUCTIONS**

Thank you for purchasing the Memorex audio system.

The serial number of your unit can be found on a label on the rear of the cabinet. We suggest that you record the serial number in the space provided below in case this information is ever needed at a future date.

**PLEASE KEEP ALL PACKAGING MATERIAL FOR AT LEAST 90 DAYS IN CASE YOU NEED TO RETURN THIS PRODUCT TO YOUR PLACE OF PURCHASE OR MEMOREX.**

Model Number: MB221

Serial Number: \_\_\_\_\_

## INSTALLATION

### BATTERY INSTALLATION:

Open the battery compartment by sliding it downward and lifting it up. **To prevent the possibility of losing the cover, it cannot be removed.** Insert two (2) "AAA" size batteries (not included) following the polarity diagram. Slide the battery compartment back in place.

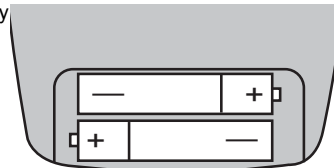

### BATTERY PRECAUTIONS

Follow these precautions when using batteries in this device:

1. Use only the size and type of batteries specified.
2. Be sure to follow the correct polarity when installing the batteries as indicated next to the battery compartment. Reversed batteries may cause damage to the device.
3. Do not mix different types of batteries together (e.g. Alkaline and Carbon-zinc) or old batteries with fresh ones.
4. If the device is not to be used for a long period of time, remove the batteries to prevent damage or injury from possible battery leakage.
5. Do not try to recharge batteries not intended to be recharged; they can overheat and rupture. (Follow battery manufacturer's directions.)

### IMPORTANT NOTE WHEN CHANGING BATTERIES:

Make sure to change the batteries within 30 seconds, otherwise the time and memory may be lost.

## LOCATION OF CONTROLS

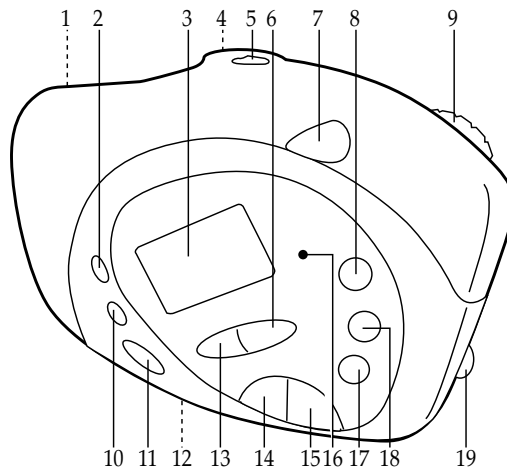

- |  |   |
|--|---|
| 1. Battery Compartment (Rear of Unit)  | 10. SNOOZE Button                           |
| 2. BASS BOOST Button                   | 11. ALARM ON/OFF Button                     |
| 3. Display                             | 12. Belt Clip release Button (Rear of Unit) |
| 4. Armband Strap Holder (Rear of Unit) | 13. MEM. UP Button                          |
| 5. Earbud Jack                         | 14. DOWN/HOUR Button                        |
| 6. MEM. DOWN Button                    | 15. UP/MINUTE Button                        |
| 7. UNLOCK/LOCK Switch                  | 16. BASS On Indicator                       |
| 8. MODE Button                         | 17. MEMORY Button                           |
| 9. VOLUME Control                      | 18. BAND Button                             |
|  | 19. POWER Button                            |

## INSTALLATION (CONTINUED)

### TO USE THE ARM STRAP

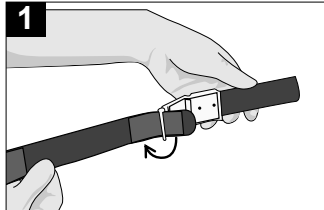

**1** Insert the belt strap into the belt clip, then fold the belt strap and fasten the velcro.

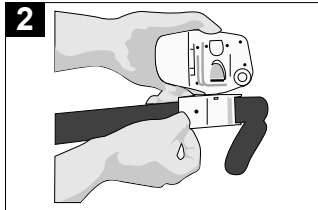

**2** Insert the belt clip into the main unit, then push the belt clip until it locks in place at the end of the belt clip holder.

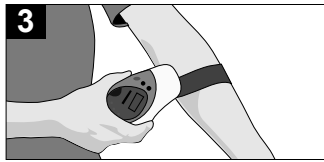

**3** Straighten the other side of the belt, then put the belt around your arm (it will rope your arm itself). Fasten the velcro so the unit is secure.

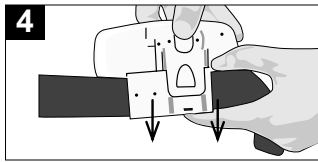

**4** **TO REMOVE THE BELT CLIP:** Press and hold the Belt Clip release button, then push the belt clip out to remove it from the unit.

## OPERATION

### EARBUDS:

Included with this unit are earbuds. Make sure the VOLUME control is at minimum and insert the earbud plug into the earbud jack on the top of the unit. Place the earbuds into your left and right ears, corresponding to the "L" and "R" mark on each earbud.

**NOTE:** You must have the earbuds plugged in to hear the alarm sound.

### TO TURN THE UNIT ON

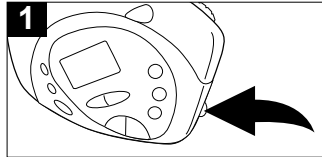

To turn the unit on, press the POWER button on the side of the unit.

### TO UNLOCK/LOCK

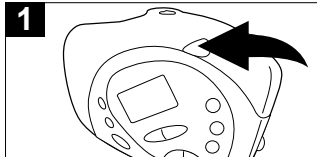

To lock the unit so no buttons can be pressed, slide the UNLOCK/LOCK switch to the LOCK position; "LOCK" will appear in the display. This is useful if listening while the unit is in your pocket, etc. Slide the UNLOCK/LOCK switch to the UNLOCK position to activate all buttons again.

### BASS BOOST

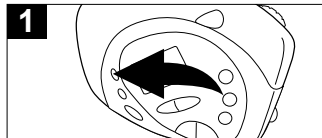

To emphasize the bass, press the BASS BOOST button to the on position; the BASS On indicator will light. Press again to turn the bass boost off.

## OPERATION (CONTINUED)

### TO LISTEN TO THE RADIO

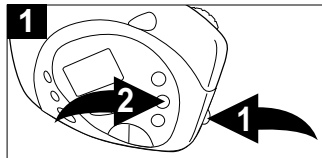

1 Insert the earbuds into the Earbud jack and press the POWER button 1 to turn the unit on; the radio frequency will appear in the display. Press the BAND button 2 to select AM or FM.

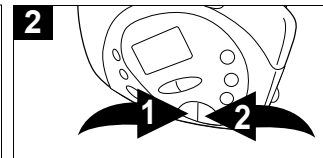

2 Tune a station using the DOWN/HOUR 1 or UP/MINUTE button 2. Press and hold the DOWN/HOUR 1 or UP/MINUTE button 2 for one second, then release, the unit will automatically scan to the next broadcasting station.

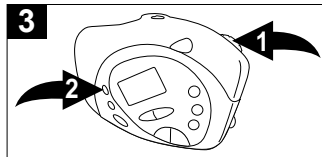

3 Adjust the VOLUME control 1 and BASS BOOST button 2 as desired.

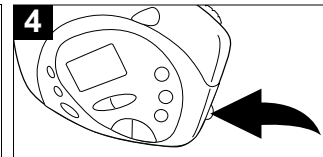

4 When done listening, press the POWER button to turn the unit off. When the unit is off, the time will appear in the display.

### Antennas

FM: Extend the earbud wire for best reception.  
AM: Turn the unit for better AM reception.

## OPERATION (CONTINUED)

### SETTING THE PRESETS (10 FM AND 10 AM)

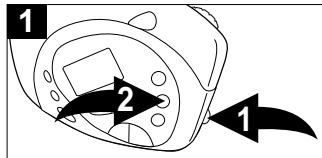

Insert the earbuds into the Earbud jack and press the POWER button ❶ to turn the unit on; the radio frequency will appear in the display. Press the BAND button ❷ to select AM or FM.

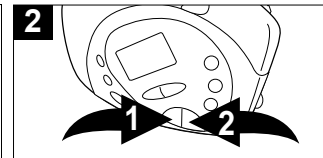

Tune a station using the DOWN/HOUR ❶ or UP/MINUTE button ❷.

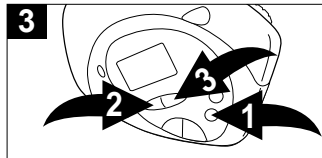

Press the MEMORY button ❶; "MEM" will blink in the display. Within four seconds, press the MEM. UP ❷ or MEM. DOWN button ❸ until the desired memory number appears on the display.

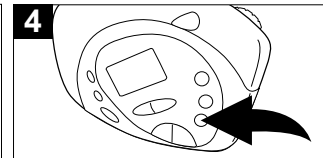

Press the MEMORY button again to set the station in the selected memory. Repeat steps 2 and 3 to program up to 10 stations in each band.

### RECALLING THE PRESETS

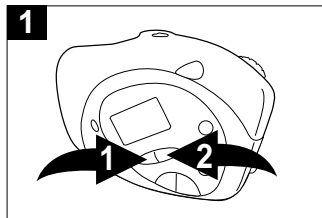

Repeat step 1 above. Press the MEM. UP ❶ or MEM. DOWN button ❷ until the desired memory number appears on the display.

## OPERATION (CONTINUED)

### TO SET OR RESET THE ACTUAL TIME

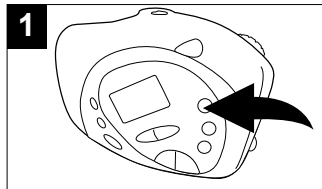

While the power is off, press and hold the MODE button; the time will blink. Release the MODE button.

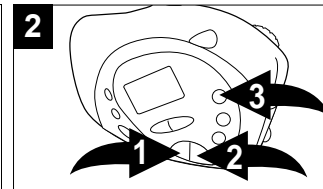

Press and hold the DOWN/HOUR button ❶ to set the present hour and then press and hold the UP/MINUTE button ❷ to set the present minute. Make sure the correct AM/PM indicator is lit. Press the MODE button ❸ again to confirm the time.

### TO SET OR RESET THE ALARM TIME

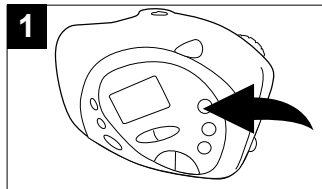

While the power is off, press and release the MODE button and the alarm time will appear. Then press and hold the MODE button; the alarm time will blink. Release the MODE button.

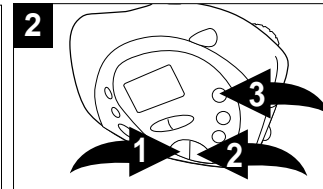

Press and hold the DOWN/HOUR button ❶ to set the alarm hour and then press and hold the UP/MINUTE button ❷ to set the alarm minute. Make sure the correct AM/PM indicator is lit. Press the MODE button ❸ again to confirm the time.

**NOTE:** If no button has been pressed for four seconds, the unit will revery back to the actual time display.



## OPERATION (CONTINUED)

### TO TURN THE ALARM ON

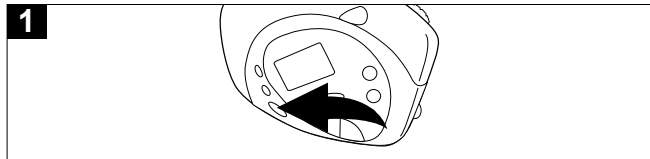

Set the alarm time as previously instructed. Press the ALARM ON/OFF button until "AL" appears in the display. When the actual time matches the selected preset alarm time, the alarm (beep sound) automatically turns on. To shut off the alarm, see TO SHUT THE ALARM OFF section below.

#### NOTES:

- You must have the earbuds plugged in to hear the alarm sound.
- The alarm will be a beeping sound; you cannot set the unit to wake to the radio sound.

### TO SHUT THE ALARM OFF

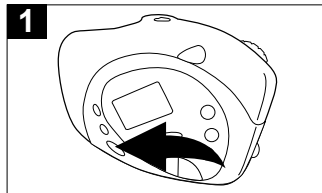

To shut the alarm off, press the ALARM ON/OFF button once and the alarm time will be reset for the next day. To turn the alarm and not set it for the next day, press the ALARM ON/OFF button again and "AL" will disappear from the display.

### SNOOZE

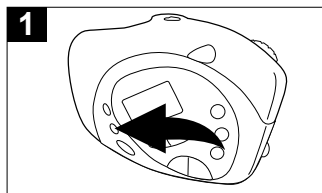

The alarm can be temporarily turned off manually by pressing the SNOOZE button; the alarm will turn back on automatically eight minutes later.

## TROUBLESHOOTING GUIDE

If you experience a problem with this unit, check the chart below before calling for service.

SYMPTOM	POSSIBLE CAUSE	POSSIBLE SOLUTION
<b>RADIO</b>		
No sound.	The earbuds are not connected.	Plug in the earbuds.
	VOLUME control at minimum position.	Increase the VOLUME control.
Noise or sound distorted on AM or FM.	AM - Interference from traffic.	Turn the radio for better AM reception.
	FM - Earbud wire is not extended.	Extend Earbud wire.
<b>CLOCK</b>		
Time not set.	Battery connected improperly, not connected or dead.	Check the battery and/or replace battery.
	Clock not set.	Set the clock.
Alarm does not sound.	Clock is not set.	Set the clock.
	Alarm time not set.	Set alarm time.

**FOR ADDITIONAL SET-UP OR OPERATING ASSISTANCE, PLEASE VISIT OUR WEBSITE AT:**

**[WWW.MEMOREXELECTRONICS.COM](http://WWW.MEMOREXELECTRONICS.COM)**

**OR CONTACT CUSTOMER SERVICE AT 1-800-919-3647.**

**PLEASE KEEP ALL PACKAGING MATERIAL FOR AT LEAST 90 DAYS IN CASE YOU NEED TO RETURN THIS PRODUCT TO YOUR PLACE OF PURCHASE OR MEMOREX.**

**FOR PARTS AND ACCESSORIES, CONTACT FOX INTERNATIONAL AT 1-800-321-6993.**

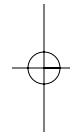
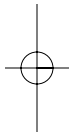

Memcorp, Inc.  
Weston, FL  
Printed in Hong Kong

Visit our website at [www.memorexelectronics.com](http://www.memorexelectronics.com)

